

Valve Seat Cutter Kits

721-82574 General Motorcycle Kit

Neway

more. Will cut seats where valve sizes range from 19mm (3/4") to 51 mm (2").

Flanders No.	Neway No.	Description
Cutters		
720-10131	131	Blades fixed at O.D. of .850" 45°
720-10132	132	Blades fixed at O.D. of .830" 32°
720-10133	133	Blades fixed at O.D. of .874" 60°
720-10122	122	1" dia. 45°
720-10123	123	1" dia. 31°
720-10111	111	1" dia. 60°
720-10120	120	1" dia. 15°
720-10270	270	1-1/4" dia. 60°
720-10607	607	1-1/4" dia. 30°
720-10608	608	1-1/4" dia. 45°
720-10205	205	1-1/2" dia. 60°
720-10622	622H	1-1/2" dia. (short hub) 31° x 46°
720-10293	293	1-3/4" dia. 60°
720-10642	642H	1-3/4" dia. (short hub) 31° x 46°
Accessories		
720-91537	TW505	T-Wrench
720-90542	TW503-1	Adaptor, 1/2" to 3/8"
721-49700	CA497	Case
720-82246	KACC26	Accessories Kit



Flanders No.	Neway No.	Description
Solid Pilots		
720-41023	100-4,0	4,0mm dia.
720-41024	100-4,02	4,02mm dia.
720-41014	100-4,5	4,5mm dia.
720-41013	100-4,52	4,52mm dia.
720-41012	100-5,0	5,0mm dia.
720-41031	100-5,02	5,02mm dia.
720-41009	100-5,5	5,5mm dia.
720-41010	100-5,52	5,52mm dia.
720-41002	100-6,0	6,0mm dia.
720-41011	100-6,6	6,6mm dia.
720-59498	140-4,5	4,5mm dia.
720-59501	140-5,0	5,0mm dia.
720-59502	140-5,5	5,5mm dia.
720-59505	140-6,0	6,0mm dia.
720-59506	140-6,6	6,6mm dia.
720-59507	140-6,98	6,98mm dia.
720-59508	140-7,0	7,0mm dia.
720-59509	140-7,02	7,02mm dia.
720-59511	140-8,0	8,0mm dia.
720-59512	140-8,02	8,02mm dia.
720-55162	140-5/16 -2	5/16" dia. -2
720-55163	140-5/16 -1	5/16" dia. -1
720-55160	140-5/16 Std	5/16" dia. Std.
720-55164	140-5/16 +1	5/16" dia. +1
720-51322	140-11/32 -2	11/32" dia. -2
720-51323	140-11/32 -1	11/32" dia. -1,
720-51320	140-11/32 Std	11/32" dia. Std.
720-51324	140-11/32 +1	11/32" dia. +1
720-53804	140-3/8 -1	3/8" dia. -1
720-53800	140-3/8 Std	3/8" dia. Std.
720-53805	140-3/8 +1	3/8" dia. +1
720-53806	140-3/8 +2	3/8" dia. +2
720-53807	140-3/8 +3	3/8" dia. +3
720-53808	140-3/8 +4	3/8" dia. +4

REV. 06-02-08

(626) 792-7384
www.FlandersCompany.com



Fax: (626) 792-5341
www.FlandersCo.com

Valve Seat Cutter Kits

721-82600 Kit for Motocross Bikes

For use on all popular motocross bikes. Additional cutters required where valve sizes are smaller than 22mm (e.g. Honda CRF 50). For KTM add two 6mm pilots: 100-6.0 and 140-6.0.

Flanders No.	Neway No.	Description
Cutters		
720-10122	122	1" dia. 45°
720-10123	123	1" dia. 31°
720-10111	111	1" dia. 60°
720-10607	607	1-1/4" dia. 30°
720-10608	608	1-1/4" dia. 45°
720-10270	270	1-1/4" dia. 60°
720-10626	626	1-1/2" dia. 30° x 45°
Solid Pilots		
720-1023	100-4.0	4mm dia.
720-41014	100-4.5	4.5mm dia.
720-41012	100-5.0	5mm dia.
720-59498	140-4.5	4.5mm dia.
720-59501	140-5.0	5.0mm dia.
720-59502	140-5.5	5.5mm dia.
Accessories		
720-91537	TW505	T-Wrench
720-90542	TW503-1	Adaptor, 1/2" to 3/8"
721-49700	CA497	Case
720-82246	KACC26	Accessories Kit



721-82563 Japanese Motorcycle Kit

For use on most metric motorcycles and ATVs, Japanese and European. Will cut seats where valve sizes range from 19mm (3/4") to 44mm (1-3/4").

Flanders No.	Neway No.	Description
Cutters		
720-10131	131	Blades fixed at O.D. of .850" 45°
720-10132	132	Blades fixed at O.D. of .830" 32°
720-10133	133	Blades fixed at O.D. of .874" 60°
720-10122	122	1" dia. 45°
720-10123	123	1" dia. 31°
720-10111	111	1" dia. 60°
720-10120	120	1" dia. 15°
720-10270	270	1-1/4" dia. 60°
720-10607	607	1-1/4" dia. 30°
720-10608	608	1-1/4" dia. 45°
720-10205	205	1-1/2" dia. 60°
720-10626	626	1-1/2" dia. 30° x 45°
Solid Pilots		
720-41023	100-4.0	4.0mm dia.
720-41014	100-4.5	4.5mm dia.
720-41012	100-5.0	5.0mm dia.
720-41009	100-5.5	5.5mm dia.
720-41010	100-5.52	5.52mm dia.
720-41002	100-6,0	6,0mm dia.
720-41011	100-6,6	6,6mm dia.
720-59501	140-5.0	5.0mm dia
720-59502	140-5.5	5.5mm dia.
720-59506	140-6,6	6,6mm dia.
720-59507	140-6,98	6,98mm dia.
720-59508	140-7,0	7,0mm dia.
720-59509	140-7,02	7,02mm dia.
720-59511	140-8,0	8,0mm dia.
720-59512	140-8,02	8,02mm dia.
Accessories		
720-91537	TW505	T-Wrench
720-90542	TW503-1	Adaptor, 1/2" to 3/8"
721-49700	CA497	Case
720-82246	KACC26	Accessories Kit

Rev. 06-02-08

Valve Seat Cutter Kits

721-82650 Japanese M/C/ATV/Marine Kit

This kit covers the most commonly serviced motorcycle, ATV, and outboard marine engines. The operating range, in terms of valve size, is from 22mm (.870") to 36mm (1.420"). This kit is not as comprehensive as the General Japanese Motorcycle Kit.

Flanders No.	Neway No.	Description
Cutters		
720-10122	122	1" dia. 45°
720-10123	123	1" dia. 31°
720-10111	111	1" dia. 60°
720-10270	270	1-1/4" dia. 60°
720-10607	607	1-1/4" dia. 30°
720-10608	608	1-1/4" dia. 45°
Solid Pilots		
720-41023	100-4,0	4.0mm dia. x 95mm
720-41014	100-4,5	4.5mm dia. x 114mm
720-41012	100-5,0	5.0mm dia. x 114mm
720-51009	100-5,5	5.5mm dia. x 114mm
720-41010	100-5,52	5.52mm dia. x 114mm
720-41002	100-6,0	6.0mm dia. x 114mm
720-41011	100-6,6	6.0mm dia. x 133mm
720-41012	140-5,0	5.0mm dia.
720-41009	140-5,5	5.5mm dia.
720-41011	140-6,6	6.6mm dia.

721-82350 Kit for Ducati

Flanders No.	Neway No.	Description
Cutters		
720-10270	270	1-1/4" dia. 60°
720-10602	602	1-1/4" dia. 31°
720-10608	608	1-1/4" dia. 45°
720-10205	205	1-1/2" dia. 60°
720-10628	628	1-1/2" dia. 31°
720-10620	620	1-1/2" dia. 45°
Solid Pilots		
720-59508	140-7,0	7,0mm dia.
720-59509	140-7,02	7,02mm dia.
720-59510	140-7,98	7,98mm dia.
720-59511	140-8,0	8,0mm dia.
720-59512	140-8,02	8,02mm dia.

721-82299 Kit for BMW

Flanders No.	Neway No.	Description
Cutters		
720-10122	122	1" dia. 45°
720-10125	125	1" dia. 75°
720-10126	126	1" dia. 30°
720-10212	212	1-1/4" dia. 1 5° x 75°
720-10607	607	1-1/4" dia. 30°
720-10608	608	1-1/4" dia. 45°
720-10216	216	1-1/2" dia. 75°
720-10623	623	1-1/2" dia. 1 5° x 30°
720-10635	635	1-5/8" dia. 1 5° x 45°
Solid Pilots		
720-41012	100-5,0	5mm dia.
720-41031	100-5,02	5,02mm dia.
720-41002	100-6,0	6,0mm dia.
720-41040	100-6,02	6,02mm dia.
720-59501	140-5,0	5,0mm dia.
720-59503	140-5,02	5,02mm dia.
720-59505	140-6,0	6,0mm dia.
720-59516	140-6,02	6,02mm dia.
720-59507	140-6,98	6,98mm dia.
720-59508	140-7,0	7,0mm dia.
720-59510	140-7,98	7,98mm dia.
720-59511	140-8,0	8,0mm dia.
Accessories for the kits on this page.		
720-91537	TW505	T-Wrench
720-90542	TW503-1	Adaptor, 1/2" to 3/8"
721-49700	CA497	Case
720-82246	KACC26	Accessories Kit



REV. 06-02-08

(626) 792-7384
www.FlandersCompany.com



Fax: (626) 792-5341
www.FlandersCo.com

Valve Seat Cutter Kits

721-82451 Harley Davidson Kit

For use on all Harley-Davidson models, except V-Rod. For five-angle capability add cutters 624 and 697.

Flanders No.	Neway No.	Description
Cutters		
720-10622	622H	1-1/2" dia. (short hub) 31° x 46°
720-10205	205	1-1/2" dia 60°
720-10293	293	1-3/4" dia. 60°
720-10642	642H	1-3/4" dia. (short hub) 31° x 46°

Solid Pilots		
720-55161	140-5/16 -3	5/16" dia. -3
720-55162	140-5/16 -2	5/16" dia. -2
720-55163	140-5/16-1	5/16" dia. -1
720-55160	140-5/16 Std	5/16" dia. Std.
720-55164	140-5/16 +1	5/16" dia. +1
720-51319	140-11/32 -4	11/32" dia. -4
720-51321	140-11/32 -3	11/32" dia. -3
720-51322	140-11/32 -2	11/32" dia. -2
720-51323	140-11/32 -1	11/32" dia. -1,
720+51320	140-11/32 Std	11/32" dia. Std.
720-51324	140-11/32 +1	11/32" dia. +1
720-53803	140-3/8 -2	3/8" dia. -2
720-53804	140-3/8 -1	3/8" dia. -1
720-53800	140-3/8 -Std	3/8" dia. Std.
720-53805	140-3/8 +1	3/8" dia. +1
720-53806	140-3/8 +2	3/8" dia. +2
720-53807	140-3/8 +3	3/8" dia. +3
720-53808	140-3/8 +4	3/8" dia. +4
720-59509	140-7.02	7,02mm dia.

Accessories		
720-91537	TW505	T-Wrench
720-90542	TW503-1	Adaptor, 1/2" to 3/8"
721-49700	CA497	Case
720-82246	KACC26	Accessories Kit



721-82470 V-Rod Upgrade Kit

Flanders No.	Neway No.	Description
Cutters		
720-10203	203	1-1/4" dia. 31° x 46°
720-10271	271	1-1/2" dia. 70°
Solid Pilots		
720-59505	140-6,0	6,0mm dia.



Rev. 06-02-08

Valve Seat Cutter Kits

721-82487 Kit for Honda		
Flanders No.	Neway No.	Description
Cutters		
720-10144	144	Blades fixed at O.D. of .758" 32°
720-10132	132	Blades fixed at O.D. of .830" 32°
720-10131	131	Blades fixed at O.D. of .850" 45°
720-10133	133	Blades fixed at O.D. of .874" 60°
720-10143	143	Blades fixed at O.D. of .925" 45°
720-10142	142	Blades fixed at O.D. of .925" 32°
720-10122	122	1" dia. 45°
720-10123	123	1" dia. 31°
720-10111	111	1" dia. 60°
720-10270	270	1-1/4" dia. 60°
720-10607	607	1-1/4" dia. 30°
720-10608	608	1-1/4" dia. 45°
720-10626	626	1-1/2" dia. 30° x 45°
Solid Pilots		
720-41021	100-3,8	3,8mm dia.
720-41022	100-3,82	3,82mm dia.
720-41023	100-4,0	4,0mm dia.
720-41024	100-4,02	4,02mm dia.
720-41014	100-4,5	4,5mm dia.
720-41013	100-4,52	4,52mm dia.
720-41055	100-4,55	4,55mm dia.
720-41012	100-5,0	5,0mm dia.
720-41031	100-5,02	5,02mm dia.
720-41009	100-5,5	5,5mm dia.
720-41010	100-5,52	5,52mm dia.
720-41011	100-6,6	6,6mm dia.
720-59501	140-5,0	5,0mm dia.
720-59502	140-5,5	5,5mm dia.
720-59506	140-6,0	6,0mm dia.
720-59615	140-6,02	6,02mm dia.
720-59508	140-6,6	6,6mm dia.
720-59507	140-6,98	6,98mm dia.

721-82460 VTX Upgrade Kit		
Cutters		
720-10645	645	1-3/4" dia. 30° x 45°
720-10205	205	1-1/2" dia. 60°
Solid Pilots		
720-59511	140-8,0	8,0mm dia.
720-59512	140-8,02	8,02mm dia.

721-82538 Kit for Kawasaki		
Flanders No.	Neway No.	Description
Cutters		
720-10131	131	Blades fixed at O.D. of .850" 45°
720-10132	132	Blades fixed at O.D. of .830" 32°
720-10133	133	Blades fixed at O.D. of .874" 60°
720-10110	110	1" dia. 46°
720-10115	115	1" dia. 31°
720-10111	111	1" dia. 60°
720-10203	203	1-1/4" dia. 31° x 46°
720-10244	244	1-1/4" dia. 15°
720-10270	270	1-1/4" dia. 60°
720-10205	205	1-1/2" dia. 60°
720-10626	626	1-1/2" dia. 30° x 45°
Solid Pilots		
720-41023	100-4,0	4mm dia.
720-41014	100-4,5	4,5mm dia.
720-41012	100-5,0	5,0mm dia.
720-41009	100-5,5	5,5mm dia.
720-41010	100-5,52	5,52mm dia.
720-59498	140-4,5	4,5mm dia.
720-59508	140-7,0	7mm dia.
720-59509	140-7,02	7,02mm dia.
720-59516	140-7,5	7,5mm dia.
720-59517	140-7,52	7,52mm dia.
720-59111	140-8,0	8,0mm dia.
720-59512	140-8,02	8,02mm dia.

Accessories for the kits on this page.					
720-91537	TW505	T-Wrench	721-49700	CA497	Case
720-90542	TW503-1	Adaptor, 1/2" to 3/8"	720-82246	KACC26	Accessories Kit

Rev. 06-02-08

Valve Seat Cutter Kits

721-82508 Kit for Suzuki

Flanders No.	Neway No.	Description
Cutters		
720-10130	130	Blades fixed at O.D. of .816" 15°
720-10131	131	Blades fixed at O.D. of .850" 45°
720-10122	122	1" dia. 45°
720-10111	111	1" dia. 60°
720-10121	121	1" dia. 15°
720-10126	126	1" dia. 30°
720-10615	615	1-3/8" dia. 15° x 45°
720-10212	212	1-1/4" dia. 15° x 75°
720-10608	608	1-1/4" dia. 45°
720-10216	216	1-1/2" dia. 75°
720-10635	635	1-5/8" dia. 15° x 45°
Solid Pilots		
720-41023	100-4,0	4mm dia.
720-41014	100-4,5	4,5mm dia.
720-41012	100-5,0	5,0mm dia.
720-41009	100-5,5	5,5mm dia.
720-41010	100-5,52	5,52mm dia.
720-41004	100-7,0	7mm dia.
720-59501	140-5,0	5mm dia.
720-59502	140-5,5	5,5mm dia.
720-59507	140-6,98	6,98mm dia.
720-59508	140-7,0	7,0mm dia.

721-82493 Kit for Yamaha

Flanders No.	Neway No.	Description
Cutters		
720-10131	131	Blades fixed at O.D. of .850" 45°
720-10138	138	Blades fixed at O.D. of .870" 20°
720-10133	133	Blades fixed at O.D. of .874" 60°
720-10122	122	1" dia. 45°
720-10123	123	1" dia. 31°
720-10127	127	1" dia. 20°
720-10111	111	1" dia. 60°
720-10203	203	1-1/4" dia. 31° x 46°
720-10205	205	1-1/2" dia. 60°
720-10642	642	1-3/4" dia. 31° x 46°
Solid Pilots		
720-41023	100-4,0	4,0mm dia.
720-41026	100-4,48	4,48mm dia.
720-41014	100-4,5	4,5mm dia.
720-41012	100-5,0	5,0mm dia.
720-41009	100-5,5	5,5mm dia.
720-41002	100-6,0	6,0mm dia.
720-41004	100-7,0	7,0mm dia.
720-59508	140-7,0	7,0mm dia.
720-59509	140-7,02	7,02mm dia.
720-59511	140-8,0	8,0mm dia.
720-59512	140-8,02	8,02mm dia.

Accessories for the kits on this page.

720-91537	TW505	T-Wrench	721-49700	CA497	Case
720-90542	TW503-1	Adaptor, 1/2" to 3/8"	720-82246	KACC26	Accessories Kit



HE 06-02-08

Valve Seat Cutters & Pilots

NEWAY VALVE SEAT CUTTERS & PILOTS

100 SERIES CUTTERS					
Flanders Number	Neway No.	Head Dia.	Head Angles	No. of Blades	Blade Part No.
720-10126	126	1.0"	30°	3	720-63250
720-10127	127	.975"	20°	3	720-63253
720-10138	138	.870"	20°	3	fixed
720-10130	130	.816"	15°	3	fixed
720-10131	131	.850"	45°	3	fixed
720-10132	132	.830"	32°	3	fixed
720-10133	133	.874"	60°	3	fixed
720-10142	142	.925"	32°	3	fixed
720-10143	143	.925"	45°	3	fixed
720-10144	144	.758"	32°	3	fixed
720-10115	115	.975"	31°	3	720-63250
720-10123	123	.975"	31°	3	720-63253
720-10122	122	.975"	45°	3	720-63253
720-10110	110	.975"	46°	3	720-63253
720-10121	121	1.0"	15°	3	720-63253
720-10120	120	1.0"	15°	3	720-63553
720-10111	111	1.0"	60°	3	720-63252
720-10125	125	1.0"	75°	3	720-63254
720-10114	114	1-1/4"	60°	3	720-63252
720-10128	128	1-1/4"	30° x 45°	3 x 3	720-63250
720-10102	102	1-5/16"	31° x 46°	3 x 3	720-63251
720-10124	124	1-5/16"	15° x 60°	3 x 3	720-63251
720-10103	103	1-1/8"	31° x 46°	3 x 3	720-63253

120 SERIES EXPANDABLE PILOTS FOR 100 SERIES CUTTERS					
Flanders Number	Pilot No.	Overall Length	Metric Dia.	Inch Dia.	Inch Fraction
720-37021	120-5.5	4.0"	5.50	.2165"	
720-37022	120-6.0	4.0"	6.00	.2362"	
720-37001	120-1/4	4.0"	6.35	.250"	1/4"
720-37023	120-6.5	4.0"	6.50	.2559"	
720-37024	120-7.0	6.0"	7.00	.2756"	
720-37002	120-9/32	6.0"	7.14	.2812"	9/32"
720-37025	120-7.5	6.0"	7.50	.2953"	
720-37027	120-5/16	6.250"	7.94	.3125"	5/16"
720-37026	120-8.0	6.250"	8.00	.3150"	

100 SERIES SOLID PILOTS FOR 100 SERIES CUTTERS					
Flanders Number	Pilot No.	Overall Length	Metric Dia.	Inch Dia.	Inch Fraction
720-41021	100-3.8	89mm	3.8	.1496"	
720-41022	100-3.82	89mm	3.82	.1504"	
720-41023	100-4.0	95mm	4	.1575"	
720-41024	100-4.02	95mm	4.02	.1583"	
720-41025	100-4.05	95mm	4.05	.1594"	
720-41012	100-5.0	114mm	5	.1969"	
720-41026	100-4.48	89mm	4.48	.1764"	
720-41014	100-4.5	89mm	4.5	.1772"	
720-41013	100-4.52	114mm	4.52	.1780"	
720-41055	100-4.55	89mm	4.55	.1790"	
720-41028	100-4.8	89mm	4.8	.1890"	
720-41029	100-4.98	89mm	4.98	.1961"	
720-41031	100-5.02	114mm	5.02	.1976"	
720-41009	100-5.5	114mm	5.5	.2165"	
720-41033	100-5.5	76mm	5.5	.2165"	
720-41010	100-5.52	114mm	5.52	.2173"	
720-41035	100-5.52	76mm	5.52	.2173"	
720-41037	100-5.55	76mm	5.55	.2185"	
720-41038	100-5.98	114mm	5.98	.2354"	
720-41002	100-6.0	114mm	6	.2362"	
720-41040	100-6.02	114mm	6.02	.2370"	
720-41041	100-6.05	114mm	6.05	.2382"	
720-41001	100-1/4	114mm	6.35	.250"	1/4"
720-41042	100-6.5	114mm	6.5	.2559"	
720-41043	100-6.58	114mm	6.58	.2591"	
720-41011	100-6.6	133mm	6.6	.2598"	
720-41045	100-6.62	114mm	6.62	.2606"	
720-41004	100-7.0	114mm	7	.2756"	
720-41047	100-7.02	114mm	7.02	.2764"	
720-41048	100-7.05	114mm	7.05	.2776"	
720-41003	100-9/32	114mm	7.14	.2812"	9/32"
720-41005	100-5/16	114mm	7.94	.3125"	5/16"
720-41007	100-8.0	114mm	8	.315"	
720-41006	100-11/32	114mm	8.73	.3437"	11/32"

REV. 06-02-08

(626) 792-7384
www.FlandersCompany.com



Fax: (626) 792-5341
www.FlandersCo.com

Valve Seat Cutters & Pilots

200 & 600 Series Cutters

Flanders Number	Cutter No.	Head Dia.	Head Angles	No. of Blades	Blade Part No.
720-10244	244	1-1/4"	15°	3	720-63250
720-10204	204	1-1/4"	15° x 46°	3 x 3	720-63250
720-10273	273	1-1/4"	15° x 60°	3 x 3	720-63250/63252
720-10212	212	1-1/4"	15° x 75°	3 x 3	720-63250/63254
720-10607	607	1-1/4"	30°	5	720-63250
720-10602	602	1-1/4"	31°	5	720-63250
720-10203	203	1-1/4"	31° x 45°	3 x 3	720-63250
720-10608	608	1-1/4"	45°	5	720-63250
720-10270	270	1-1/4"	60°	3	720-63252
720-10222	222	1-1/4"	70°	3	720-63252
720-10210	210	1-1/4"	75°	3	720-63252
720-10201	201	1-3/8"	31° x 46°	3 x 3	720-63250/63251
720-10611	611	1-3/8"	31°	5	720-63250
720-10612	612	1-3/8"	15° x 46°	3 x 5	720-63250
720-10615	615	1-3/8"	15° x 45°	3 x 3	720-63250
720-10616	616	1-3/8"	30° x 45°	5 x 5	720-63251
720-10618	618	1-1/2"	35° x 60°	5 x 5	720-63250/63252
720-10239	239	1-1/2"	11° x 45°	3 x 3	720-63251
720-10623	623	1-1/2"	15° x 30°	3 x 5	720-63250
720-10625	625	1-1/2"	15° x 45°	3 x 5	720-63251
720-10621	621	1-1/2"	15° x 46°	3 x 5	720-63251
720-10213	213	1-1/2"	15° x 50°	3 x 3	720-63251/63254
720-10234	234	1-1/2"	39° x 45°	3 x 3	720-63251
720-10626	626	1-1/2"	30° x 45°	5 x 5	720-63251
720-10208	208	1-1/2"	31° x 46°	3 x 3	720-63251
720-10622	622H	1-1/2"	31° x 46°	5 x 5	720-63251
720-10205	205	1-1/2"	60°	3	720-63254
720-10271	271	1-1/2"	70°	3	720-63254
720-10216	216	1-1/2"	75°	3	720-63254
720-10635	635	1-5/8"	15° x 45°	5 x 5	720-63251
720-10631	631	1-5/8"	15° x 45°	3 x 5	720-63251
720-10237	237	1-5/8"	30° x 45°	3 x 3	720-63251
720-10641	641	1-3/4"	15° x 46°	3 x 5	720-63251
720-10642	642H	1-3/4"	31° x 45°	5 x 5	720-63251
720-10643	643	1-3/4"	15° x 60°	5 x 5	720-63251/63254
720-10645	645	1-3/4"	20° x 45°	5 x 5	720-63251
720-10293	293	1-3/4"	60°	3	720-63254
720-10647	647	2"	30°	2	720-63250
720-10652	652	2"	31° x 46°	5 x 5	720-63251
720-10657	657	2"	60°	5	720-63254

150 Series EXPANDABLE PILOTS for 200 & 600 Series Cutters

Flanders Number	Pilot No.	Overall Length	MM Dia.	Inch Dia.	Fraction Dia.
720-37029	150-6.5	6"	6.5	.2559"	
720-37030	150-7.0	6"	7	.2756"	
720-37006	150-9/32	6"	7.14	.2812"	9/32"
720-37031	150-7.5	6"	7.5	.2953"	
720-37007	150-5/16	6-1/2"	7.94	.3125"	5/16"
720-37032	150-8.0	6-1/2"	8	.3150"	
720-37033	150-8.5	6-1/2"	8.5	.3346"	
720-37008	150-11/32	6-1/2"	8.73	.3437"	11/32"
720-37009	150-3/8	7"	9.53	.3750"	3/8"

140 Series Pilots for 200 & 600 Series Cutters

Flanders Number	Pilot No.	Overall Length	MM Dia.	Inch Dia.	Fraction Dia.
720-59501	140-5.0	152mm	5	.1969"	
720-59503	140-5.02	152mm	5.02	.1976"	
720-59502	140-5.5	152mm	5.5	.2165"	
720-59504	140-5.52	152mm	5.52	.2173"	
720-59505	140-6.0	152mm	6	.2362"	
720-59615	140-6.02	152mm	6.02	.2370"	
720-59506	140-6.6	152mm	6.6	.2598"	
720-59507	140-6.98	152mm	6.98	.2748"	
720-59508	140-7.0	152mm	7	.2756"	
720-59509	140-7.02	152mm	7.02	.2764"	
720-59321	140-9/32-1	5-1/4"	7.12	.2802"	9/32-.001"
720-59320	140-9/32	5-1/4"	7.14	.2812"	9/32" Std.
720-59322	140-9/32+1	5-1/4"	7.17	.2822"	9/32+.001"
720-59323	140-9/32+2	5-1/4"	7.19	.2832"	9/32+.002"
720-59515	140-7.48	152mm	7.48	.2945"	
720-59614	140-19/64-2	6"	7.49	.2949"	19/64-.002"
720-59516	140-7.50	152mm	7.5	.2953"	
720-59613	140-19/64-1	6"	7.51	.2959"	19/64-.001"
720-59517	140-7.52	152mm	7.52	.2961"	
720-59610	140-19/64	6"	7.54	.2969"	19/64" Std.
720-59611	140-19/64+1	6"	7.56	.2979"	19/64+.001"
720-59612	140-19/64+2	6"	7.59	.2989"	19/64+.002"
720-55159	140-5/16-4	152mm	7.84	.3085"	5/16-.004"
720-55161	140-5/16-3	6"	7.86	.3095"	5/16-.003"

REV. 06-02-08



Valve Seat Cutters

140 Series Pilots for 200 & 600 Series Cutters . . . Continued

Flanders Number	Pilot No.	Overall Length	MM Dia.	Inch Dia.	Fraction Dia.
720-55163	140-5/16-1	6"	7.91	.3115"	5/16-.001"
720-55160	140-5/16	6"	7.94	.3125"	5/16" Std.
720-55164	140-5/16+1	6"	7.96	.3135"	5/16+.001"
720-59510	140-7.98	6"	7.98	.3142"	
720-55165	140-5/16+2	6"	7.99	.3145"	5/16+.002"
720-59511	140-3.0	152mm	8	.3150"	
720-59512	140-3.02	152mm	8.02	.3157"	
720-51319	140-11/32-4	6-1/2"	8.62	.339"	11/32-.004"
720-51321	140-11/32-3	6-1/2"	8.65	.3407"	11/32-.003"
720-51322	130-11/32-2	6-1/2"	8.68	.3417"	11/32-.002"
720-51323	140-11/32-1	6-1/2"	8.7	.3427"	11/32-.001"
720-51320	140-11/32	6-1/2"	8.73	.3437"	11/32" Std.
720-51324	140-11/32+1	6-1/2"	8.76	.3447"	11/32+.001"
720-51325	140-11/32+2	6-1/2"	8.8	.3457"	11/32+.002"
720-51326	140-11/32+3	6-1/2"	8.81	.3468"	11/32+.003"
720-51327	140-11/32+4	6-1/2"	8.83	.3478"	11/32+.004"
720-51328	140-11/32+5	6-1/2"	8.86	.3488"	11/32+.005"
720-59524	140-9.0	165mm	9	.3543"	
720-59525	140-9.02	165mm	9.02	.3551"	
720-53801	140-3/8-4	7"	9.4	.3700"	3/8-.004"
720-53802	140-3/8-3	7"	9.45	.3720"	3/8-.003"
720-53803	140-3/8-2	7"	9.47	.3730"	3/8-.002"
720-53804	140-3/8-1	7"	9.5	.3740"	3/8-.001"
720-53800	140-3/8	7"	9.53	.3750"	3/8" Std.
720-53805	140-3/8+1	7"	9.55	.3760"	3/8+.001"
720-53806	140-3/8+2	7"	9.58	.3770"	3/8+.002"
720-53807	140-3/8+3	7"	9.6	.3780"	3/8+.003"
720-53808	140-3/8+4	7"	9.63	.379"	3/8+.004"
720-53809	140-3/8+5	7"	9.65	.3800"	3/8+.005"
720-53810	140-3/8+6	7"	9.68	.3810"	3/8+.006"
720-53811	140-3/8+7	7"	9.7	.382"	3/8+.007"



REV. 06-02-08

Valve Seat Cutters

Neway Parts and Accessories

Nylon T-Wrench



720-90513 3/8"
720-90505 1/2"

T-Wrench

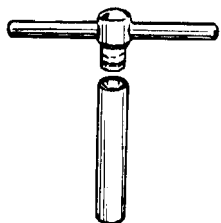

720-91008 3-Piece
720-91537 2-Piece

720-90245 Pilot Puller Pin



720-90260 Flat Head Screw

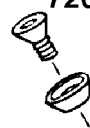

720-90265 Lg. Wedge Blade Lock
720-90266 Sm. Wedge Blade Lock

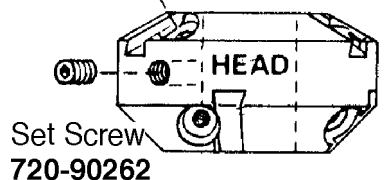

720-90267 Brush



720-95001 Instruction Manual



721-90709 1/2 pint Valve seat cutting fluid

720-90542 Adaptor 1/2 male to 3/8 female to use 720-91537 on 100 series cutters

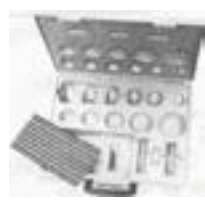

721-49700 Large plastic case for larger kits

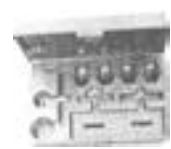

721-30300 Small plastic case

Flanders Number	Description	Application
720-90245	Pilot Puller Pin	For All Pilots
720-82246	Parts Kit	Contains: Brush, Puller Pin, 5/64" Hex Key
720-90260	Flat Head Allen Screw 5-40	Blade Lock Screw
720-90262	Set Screw Allen 10-32	Hub Lock Screw
720-90265	Wedge for Blade Lock Screw	200 & 600 Cutters
720-90266	Wedge for Blade Lock Screw	100 Cutters
720-90267	Brush, Stiff Bristle	Clean Cutter Heads
720-90542	Socket Adaptor Only 3/8" Hex	For 100 Cutters
720-91008	T-Wrench (3 Piece) w/Adaptor for 3/8" & 1/2" Drive	100, 200 & 600 Cutters
720-91537	T-Wrench (2 Piece) 1/2" Drive	200 & 600 Cutters
720-90513	3/8" Nylon T-Wrench	100 Cutters
720-90505	1/2" Nylon T-Wrench	200 & 600 Cutters

Carbide Blades For Neway Cutter Heads



Seat Blade
720-63250 3/8" length
720-63251 1/2" length
720-63253 5/16" length



Narrowing Blade
720-63252 1/2" length
720-63254 3/4" length



Blending Blade
720-63259 3/4" length
720-63352 1/2" length



Special Blade
720-63553 5/16" length

